

# BRAVO SNORKEL



## VOLKSWAGEN T5 / T6

VARIANT: 2.0 LHD (2003 - )

REF: SVW6

FITMENT SIDE: Right

### LINEAR LOW DENSITY POLYETHYLENE RESINE



LL 8446 is a linear low density butene copolymer designed to offer excellent processability, whiteness, and fast grinding rate. This UV stabilized resin is ideally suited for applications that require excellent dimensional control and low warpage.

### PROPERTIES

**Additive**

Long Term UV-8 Stabilizer

**Density**

0.936 g/cm<sup>3</sup> (Based on ISO 1183)

**Melt Index (190°/2.16 Kg)**

5.0 g/10min (Based on ISO 1183)

PART	DESCRIPTION	QTY
1	Snorkel body	x1
2	Snorkel head 89 mm / 3,5"	x1
3	Black clamp 78 - 101 mm	x1
4	Bracket upper mounting	x1
5	Screw 4 x 16 mm	x3
6	SEMS bolt M6 x 14 mm	x2
7	Nylon insert	x3
8	Installation template	x1
9	Allen screw M6 x 30 mm	x2
10	Washer 6 x 20 mm	x2
11	Rivnut M6 x 14 mm	x2
12	Rubber duct connecting	x1

PART	DESCRIPTION	QTY
13	LLDPE duct connecting	x1
14	Clamp 100 - 120 mm	x5
15	Rubber duct connecting	x1
16	Metal ring	x1
17	Rubber duct connecting	x1
18	Optional ring adapter	x1
19	Allen screw M5 x 6 mm	x4
20	Inner cutting template	x1

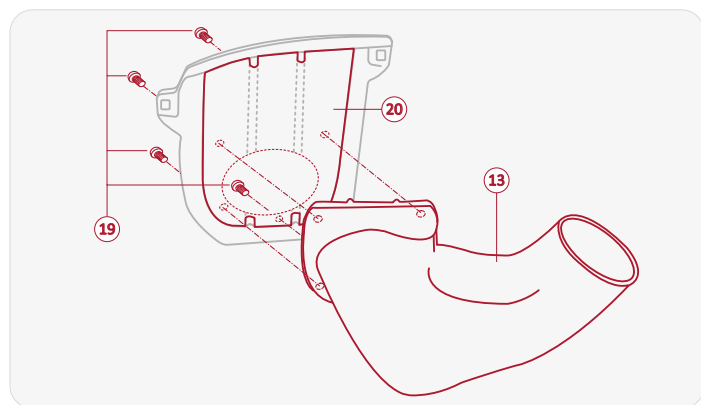
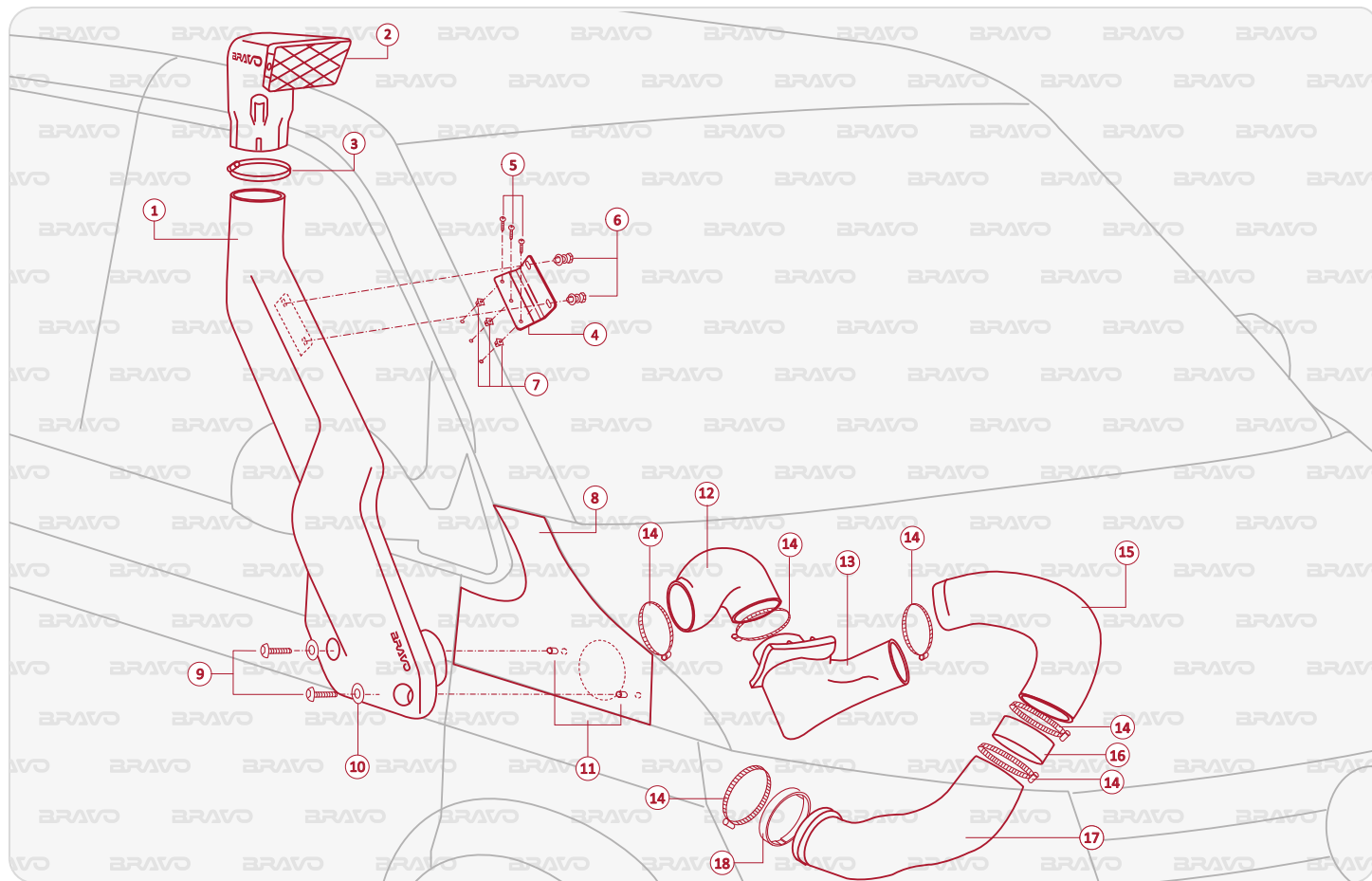

Installation process is under installer's responsibility.